



**NEW MEXICO  
COUNTIES**  
33 STRONG

# **2019 Legislative Conference**



**January 15-17, 2019  
Santa Fe, NM**

# NMC BUSINESS PARTNERS

## **Enchantment**

CES (Cooperative Educational Services)  
LECET Southwest

## **Zia**

Ambitions Consulting Group  
Automated Election Services  
Delta Dental  
Dominion Voting  
Holt Mynatt Martinez P.C.  
Kofile Technologies, Inc.  
New Mexico Finance Authority  
Pavement Sealants & Supply, Inc.  
Pettigrew & Associates P.A.  
Professional Document Systems  
RBC Capital Markets LLC  
Siddons-Martin Emergency Group  
Souder, Miller & Associates  
Triadic Enterprises, Inc.  
Tri-State Generation and Transmission Assoc., Inc.  
Wagner Equipment Co.

## **Roadrunner**

Bohannon Huston, Inc.  
Brasier Asphalt  
Computer Information Systems, Inc.  
CorrHealth  
Diamond Pharmacy Services  
Dustrol, Inc.  
Forte Payment Systems  
Hilltop Securities  
Holly Frontier Refining & Marketing LLC  
Indigent Healthcare Solutions  
Inland Kenworth US, Inc.  
Kubiak Melton & Associates LLC  
MCT Industries, Inc.  
Mooring USA-NM  
PNM Resources  
PREAAmerica LLC  
Public Trust Advisors LLC  
SDV Construction, Inc.  
SealMaster Albuquerque  
Summit Truck Group  
The Railroad Yard, Inc.  
Total Assessment Solutions Corp  
VFIS  
VitalCore Health Strategies  
Waste Management of New Mexico  
Wilson & Company  
Wells Fargo Government Banking

## **Yucca**

Santa Fe Education Trust Board

# TABLE OF CONTENTS

NMC Legislative Priorities.....	4
Welcome.....	5
Schedule of Events.....	7
Conference Information.....	8-11
Site Maps.....	13-15
NMC Staff.....	17
Board of Directors.....	18
Executive Committee.....	19
Advisory Council.....	19
Multi-Line Pool Board.....	20
Workers' Compensation Pool Board.....	20
NM EDGE.....	23
NM EDGE Road Map.....	24-26
Sponsors & Exhibitors.....	28-29
Sponsors' Reception.....	30
Workshop Blocks.....	32-33
Opening Session.....	35
Legislative Reception.....	36
Legislative Breakfast.....	38-39
Closing Luncheon.....	41
Affiliate Meeting Locations.....	43
g11 Directors.....	44
Assessors.....	45
Attorneys.....	46
Clerks.....	47
Commissioners.....	48
Cooperative Extension Service.....	49
Detention Administrators.....	50-51
DWI Coordinators.....	52
Finance & Purchasing.....	53
Fire & Emergency Managers.....	54
GIS/Rural Addressing.....	55
Health Services.....	56
Human Resources.....	57
Information Technology.....	58
Managers.....	59
Probate Judges.....	60
Public Works.....	61
Risk Management.....	62
Sheriffs.....	63
Treasurers.....	64

# LEGISLATIVE PRIORITIES

The following were selected as priorities by the NMC Board of Directors for the 2019 session:

## **Behavioral Health**

Authorize HSD to provide behavioral health services to adults and juveniles who have behavioral health diagnoses and who are housed in county detention centers.

## **Fire Protection Fund**

Remove the State Fire Marshal's Office and Fire Protection Fund from the PRC to improve advocacy and communication and fund protection and carryover for operations and major purchases.

## **HB2 Appropriations**

- Detention Reimbursement Fund—Restore to the original appropriation of \$5 million.
- Prisoner Transport & Extradition—Create a line item in the DFA budget with \$750,000 to reimburse counties that provide transportation for state prisoners.
- EMS Funding—Appropriate \$5 million annually to the EMS Fund and identify a designated revenue mechanism for growth and stability.

## **Tax Reform**

Support efforts that improve economic efficiency, economic development, ease of administration, and ensure fairness of the tax system. NMC to be included in restructure and reform efforts of the state and local tax system (seat at the table).

## **Forfeiture Act Reform**

Address unintended consequences of the 2015 amendments to the NM Forfeiture Act. Fix the confusion around abandoned property; provide for reimbursement to local law enforcement agencies; extend due process protections to local DWI vehicle seizures; and exclude limited equitable sharing provisions contained in the 2017 & 2018 bills.

Dear Members, Partners, and Friends:

Welcome to the 2019 New Mexico Counties (NMC) Legislative Conference! We extend a warm welcome to over 800 county elected officials, county employees, and state officials from throughout the great state of New Mexico. We encourage you to attend our affiliate meetings and to engage in conversation on issues facing counties today.

This is the First Session of the 54th New Mexico Legislature, which is a 60-day session. We hope that you will be able to stop by the Roundhouse and visit with your state Senators and Representatives. Please encourage them to keep the counties in mind as they consider legislation this session.

Our conference will kick off with the Sponsor's Reception on Tuesday night in the Exhibit Hall. On Wednesday morning, NMC will offer two Workshop Blocks focusing on Behavioral Health, Legislative Priorities, and Finance & Auditing. Wednesday evening we will provide an ideal networking opportunity at the Legislative Reception and Dance at the Eldorado Hotel and Spa. Wrapping up our conference on Thursday, we have invited the Governor, our congressional delegation, state elected officials, cabinet secretaries, and state legislators to attend the Legislative Breakfast. The Closing Session and Luncheon on Thursday afternoon will feature the NM EDGE graduation ceremony.

To all our sponsors and exhibitors: THANK YOU for your support of NMC and all 33 counties throughout the state! This conference would not be possible without the financial support you provide to NMC and our members, and we know that county elected officials and employees value your products and services.

Sincerely,



Rebecca Long  
NMC President &  
Lea County Commissioner



Steve Kopelman  
NMC Executive Director

# *Thank You!* **to our Sponsors**

**Ambitions Consulting Group**

**CES (Cooperative Educational  
Services)**

**Dominion Voting**

**HollyFrontier Refining &  
Marketing**

**Holt Mynatt Martinez P.C.**

**NCIC Inmate Communications**

**New Mexico Finance Authority**

**Professional Document  
Systems**

**Tri-State Generation**

# SCHEDULE OF EVENTS

Drury Plaza Hotel (Drury)  
Eldorado Hotel & Spa (Eldorado)  
Santa Fe Community Convention Center (SFCCC)

## **Monday, January 14**

8:30 a.m. - 8:30 p.m. NM EDGE Courses (Drury)  
2:00 p.m. - 5:00 p.m. Conference Registration (SFCCC)

## **Tuesday, January 15**

8:30 a.m. - 4:00 p.m. NM EDGE Courses (Drury)  
8:00 a.m. - 5:00 p.m. Conference Registration (SFCCC)  
8:00 a.m. - 12:00 p.m. Multi-Line Membership Meeting & Special Joint Pools/Fund Meeting (Eldorado)  
12:00 p.m. Legislative Session Opens  
2:00 p.m. - 5:00 p.m. NMC BOD Meeting (Eldorado)  
5:00 p.m. - 7:00 p.m. Exhibit Hall Open (SFCCC)  
5:00 p.m. - 7:00 p.m. Sponsors' Reception (SFCCC)

## **Wednesday, January 16**

8:30 a.m. - 11:30 a.m. NM EDGE Courses (Drury)  
8:00 a.m. - 5:00 p.m. Conference Registration (SFCCC)  
8:00 a.m. - 5:00 p.m. Exhibit Hall Open (SFCCC)  
8:30 a.m. - 9:45 a.m. Workshop Block I (SFCCC)  
10:15 a.m. - 11:30 a.m. Workshop Block II (SFCCC)  
1:00 p.m. - 2:15 p.m. Opening Session (SFCCC)  
2:30 p.m. - 5:00 p.m. Affiliate Meetings (Various Locations)  
5:30 p.m. - 10:30 p.m. Legislative Reception & Dance (Eldorado)

## **Thursday, January 17**

7:00 a.m. - 12:00 p.m. Conference Registration/Info (SFCCC)  
7:15 a.m. - 8:30 a.m. Legislative Breakfast (SFCCC)  
8:30 a.m. - 1:30 p.m. Exhibit Hall Open (SFCCC)  
8:45 a.m. - 11:45 a.m. Affiliate Meetings (Various Locations)  
12:00 p.m. - 1:30 p.m. Closing Session Luncheon with NM EDGE Graduation (SFCCC)

# INFORMATION

## **NMC Meetings & Events Policy**

Individuals may not engage in political activities or distribute campaign literature at NMC sponsored meetings or events. Literature will be removed and those who continue to violate this policy may be asked to leave the event.

## **Registration Desk**

The NMC Registration Desk will be at the SFCCC. Our staff will be available to answer your questions throughout the conference. Please visit the Registration Desk should you need any information or special assistance.

## **Name Badges**

NMC requests that all conference participants wear their name badge to all meetings and events. During daytime events, individuals without name badges will be asked to return to the conference registration desk to verify their registration and receive a duplicate name badge. During evening events, participants without their name badges will be asked to return to their hotels to retrieve them in order to attend the event.

Guests of attendees may purchase a guest ticket and badge at the registration desk for conference events. Guest tickets will also be available for purchase at the door for social events. A limited number of event tickets may be available based on space availability.

## **Conversations & Electronic Devices**

As a courtesy to all attendees, we ask that you silence electronic devices and refrain from conversations during all meetings and general sessions.

## **Drink Tickets**

Drink tickets will be distributed to attendees when they check in for registration. Drink tickets are only valid at the specific event and date identified on the ticket.



## **Consumption of Alcohol**

NMC requests that all attendees and guests adhere to the "Alcohol Consumption Policy" of the NMC Conference Meetings Policies. These policies are available by contacting the NMC office or by downloading them from the NMC website. Alcohol shall be consumed in a responsible manner. NMC encourages individuals to use designated drivers or call for a cab when drinking. NMC provides transportation to and from all events that serve alcohol. The vendor of alcoholic beverages at our events reserves the right and has the responsibility to refuse service when appropriate.

Hospitality suites of any kind are not allowed at NMC conferences or meetings, whether in a private room or public area.

.....

## **Emergency Services**

Christus St. Vincent Regional Medical Center  
455 St. Michaels Drive  
Santa Fe, NM 87505  
(505) 913-3361

***\*\*For ALL emergency situations call 911\*\****

.....

## **Hotel/Convention Center Information**

### **Eldorado Hotel and Spa**

309 W San Francisco St.  
Santa Fe, NM 87501  
(505) 995-4507

### **Drury Plaza Hotel**

828 Paseo del Peralta  
Santa Fe, NM 87501  
(505) 424-2175

### **Santa Fe Community Convention Center**

201 W Marcy St.  
Santa Fe, NM 87501  
(800) 984-9984

**Shuttle Transportation**

Complimentary shuttles will be provided for attendees to and from the Eldorado Hotel & Spa, the Drury Plaza Hotel, and the Santa Fe Community Convention Center. Shuttle service will be provided to and from the Eldorado Hotel and the Roundhouse for guests to attend the opening session of the Legislature. Shuttles to and from participating locations will only be available for scheduled events. Shuttles will not pick-up or drop-off at alternative locations or hotels. Please refer to the shuttle schedule below for times and pick-up locations.

**Monday, January 14**  
No Shuttle Service

**Tuesday, January 15**  
11:00 a.m. - 3:00 p.m.      Shuttles to/from Eldorado/  
Roundhouse  
4:30 p.m. - 7:30 p.m.      Shuttles to/from SFCCC/  
Hotels

**Wednesday, January 16**  
8:00 a.m. - 11:00 p.m.      Shuttles to/from SFCCC/  
Hotels

**Thursday, January 17**  
6:30 a.m. - 2:30 p.m.      Shuttles to/from SFCCC/  
Hotels

.....  
**Pick-Up/Drop-Off Locations**

Eldorado Hotel and Spa  
*Pick-up/Drop-off on Johnson Street*

Drury Plaza Hotel  
*Pick-up/Drop-off in hotel lobby turnaround*

Santa Fe Community Convention Center  
*Pick-up/Drop-off on Grant Street, in loading zone*

**Parking Information**

Parking is available onsite at the Santa Fe Community Convention Center for \$12.00 per vehicle, per day. This does not include in/out privileges. Entrance to the parking garage is located off of South Federal Place.

## **Special Events**

### **Tuesday, January 15**

5:00 p.m. - 7:00 p.m. Sponsors' Reception (SFCCC)

### **Wednesday, January 16**

1:00 p.m. - 2:15 p.m. Opening Session (SFCCC)

2:30 p.m. - 5:00 p.m. Affiliate Meetings  
(Various Locations)

5:30 p.m. - 10:30 p.m. Legislative Reception and  
Dance (Eldorado)

### **Thursday, January 17**

7:15 a.m. - 8:30 a.m. Legislative Breakfast  
(SFCCC)

12:00 p.m. - 1:30 p.m. Closing Session Luncheon  
with NM EDGE Graduation  
(SFCCC)

## **Affiliate Meeting Locations & Breaks**

### **Wednesday, January 16**

2:30 p.m. - 5:00 p.m. Affiliate Meetings  
(Various Locations)

3:30 p.m. - 4:00 p.m. Break Service  
(Various Locations)

### **Thursday, January 17**

8:45 a.m. - 11:45 a.m. Affiliate Meetings  
(Various Locations)

10:00 a.m. - 10:30 a.m. Break Service  
(Various Locations)

## **Exhibitors & Sponsors**

Please make sure to visit this year's sponsors and exhibitors. Without them, this conference would not be possible!

### **Tuesday, January 15**

5:00 p.m. - 7:00 p.m. Exhibit Hall Open (SFCCC)

### **Wednesday, January 16**

8:00 a.m. - 5:00 p.m. Exhibit Hall Open (SFCCC)

### **Thursday, January 17**

8:30 a.m. - 1:30 p.m. Exhibit Hall Open (SFCCC)



HOLLYFRONTIER®

**HollyFrontier Refining  
& Marketing LLC**  
“Partners in Road Improvements”

Albuquerque, NM  
Artesia, NM

Phone: (800) 548-3010 or  
(505) 344-3526

Suppliers of asphalts, emulsions, and  
technical services to meet your needs.



NEW MEXICO  
**FINANCE AUTHORITY**

***THE BENCHMARK* for New  
Mexico communities seeking to  
finance infrastructure projects**

**Visit [www.NMFA.net](http://www.NMFA.net) or contact  
a Lending Officer at  
877-ASK-NMFA to learn more**

Santa Fe Community Convention Center

1st Floor Meeting Rooms

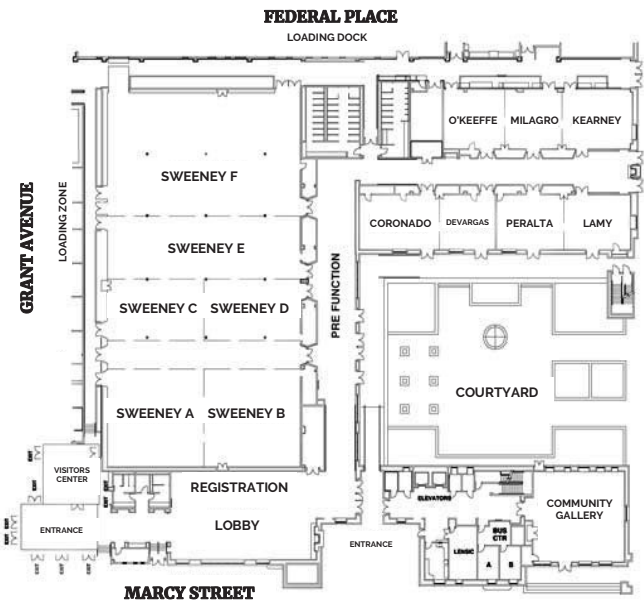

2nd Floor Meeting Rooms

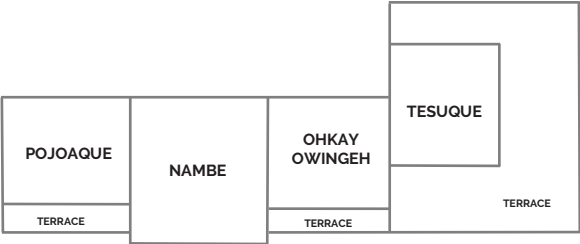

Eldorado Hotel and Spa

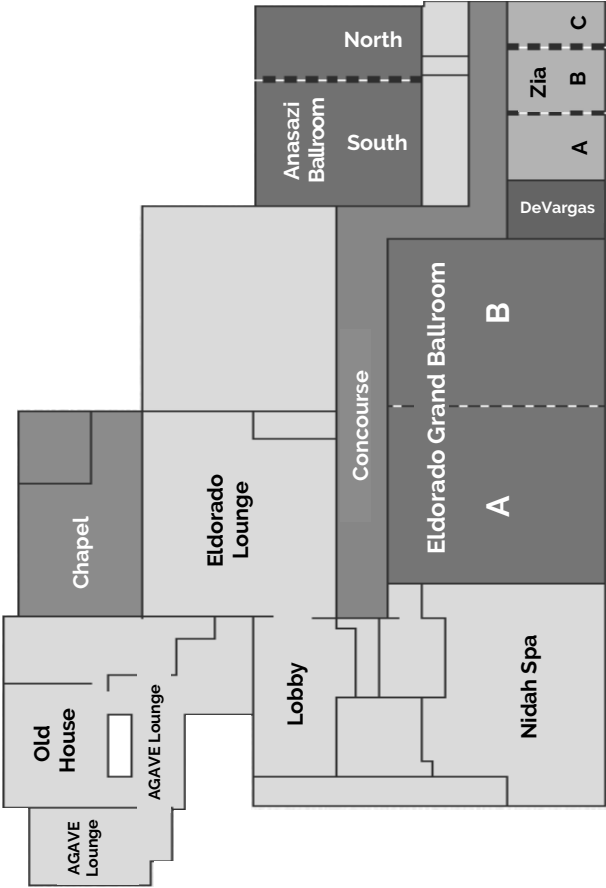

## Drury Plaza Hotel

**Main Building  
1st Floor**

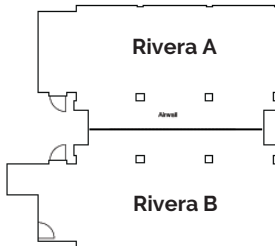

**Main Building  
2nd Floor**

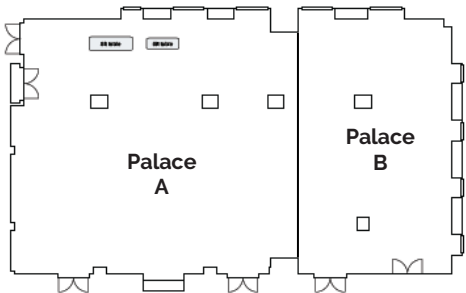

**Building Near Valet**

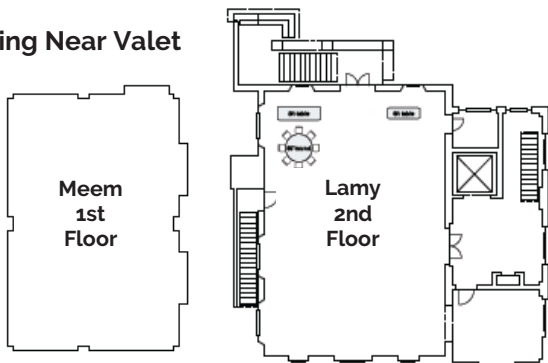

**Building  
at  
Front  
of  
Parking  
Structure**

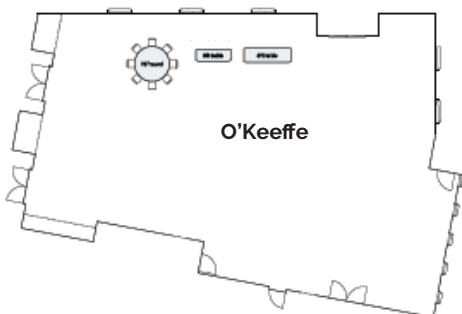



PERFORM. LIKE NO OTHER.™

***Siddons-Martin***  
***Emergency Group***

---

***Protecting the Southwest***



**PETTIGREW**  
**& ASSOCIATES PA**

ENGINEERING | SURVEYING | TESTING  
DEFINING QUALITY SINCE 1965



## **Administration**

Steve Kopelman, Executive Director  
Grace Philips, General Counsel  
Susan Mayes, Communications Director  
Brian Moore, Government Relations

## **Legal Bureau**

Brandon Huss, Legal Bureau Chief  
Mark Drebing, Litigation Attorney  
Felicia Blea-Rivera, Litigation Attorney  
Joni Deniston, Paralegal  
Oksana Vivchar, Paralegal

## **Finance Department**

Santiago Chavez, Finance & Administration Director  
Carolyn Rios, Controller  
Charlotte Martinez-Gallegos, Accountant  
Caryl Rodriguez, Accounting Specialist  
Roberta Lujan, Receptionist/Office Manager Assistant

## **Government Affairs**

Joy Esparsen, Government Affairs Director  
Aelysea Webb, Government Affairs Specialist  
Talía Storch, Meetings Coordinator  
Clarissa Baca, Member Services Coordinator

## **Risk Management**

Taylor Horst, RM Director  
Kiki Arellano, RM Specialist  
Lori Urban, RM Data Analyst

## **Loss Prevention**

Bonnie Cummings, LP Manager  
Patrick Trujillo, LP Attorney  
James Chavez, LP Specialist  
Art Murphy, LP Specialist  
Greg Rees, LP Specialist

## **Multi-Line**

Robin Martinez, ML Claims Manager  
Velma Herrera, ML Sr. Claims Examiner  
Jennifer Ortiz, ML Sr. Claims Examiner  
Randy Chavez, ML Claims Examiner  
Bobbi Dalton, ML Claims Examiner  
Latoya Ferguson, ML Claims Examiner  
Carol Riordan, ML Claims Examiner  
Kayla Montoya, ML Administrative Assistant

## **Workers' Compensation**

Kamie Denton, WC Claims Manager  
Pamela Lowrance, WC Claims Adjuster  
Jaime Dalton, WC Claims Adjuster  
Cynthia Stephenson, WC Claims Adjuster  
Annemarie Hill, Medical Only Adjuster  
Ellen Chavez, Nurse Case Manager  
Patricia Lovato, Administrative Assistant

# NMC BOARD OF DIRECTORS

<b>President</b>	Rebecca Long
<b>President Elect</b>	Mark Cage
<b>Vice President</b>	Steven Boyle
<b>Past President</b>	Tyler Massey
<b>Treasurer</b>	Ed Moreno

Bernalillo County	Linda Stover, Clerk
Catron County	TBD
Chaves County	Dave Kunko, Clerk
Cibola County	TBD
Colfax County	James Newton, Commissioner
Curry County	Wesley Waller, Sheriff
De Baca County	TBD
Doña Ana County	TBD
Eddy County	Mark Cage, Sheriff
Grant County	TBD
Guadalupe County	Ernest Tapia, Commissioner
Harding County	Phillip Trujillo, Assessor
Hidalgo County	Tyler Massey, Treasurer
Lea County	Rebecca Long, Commissioner
Lincoln County	Robert Shepperd, Sheriff
Los Alamos County	Pete Sheehey, Councilor
Luna County	Linda Smrkovsky, Commissioner
McKinley County	TBD
Mora County	TBD
Otero County	Steven Boyle, Assessor
Quay County	Mike Cherry, Commissioner
Rio Arriba County	Linda Padilla, Clerk
Roosevelt County	Dennis Lopez, Commissioner
San Juan County	Jim Crowley, Commissioner
San Miguel County	Janice Varela, Commissioner
Sandoval County	David Heil, Commissioner
Santa Fe County	Geraldine Salazar, Clerk
Sierra County	Glenn Hamilton, Sheriff
Socorro County	Manuel Anaya, Commissioner
Taos County	Gabriel Romero, Commissioner
Torrance County	TBD
Union County	Justin Bennet, Commissioner
Valencia County	Jhonathan Aragon, Commissioner

## **Ex-Officio Members**

NACo Board	Tyler Massey, Hidalgo County
NACo Board	Jhonathan Aragon, Valencia County
NACo WIR Board	William Cavin, Chaves County
NACo WIR Board	Ernest Tapia, Guadalupe County
Multi-Line Pool Board	Jim Fambro, Taos County
Workers' Comp Pool Board	Vacant
NMC Executive Director	Steve Kopelman

# EXECUTIVE COMMITTEE

<b>President</b>	Rebecca Long
<b>President Elect</b>	Mark Cage
<b>Vice President</b>	Steven Boyle
<b>Past President</b>	Tyler Massey
<b>Treasurer</b>	Ed Moreno

District One	Pete Sheehey, Los Alamos Councilor
District Two	Gabriel Romero, Taos County Commissioner
District Three	TBD
District Four	TBD
District Five	Linda Smrkovsky, Luna County Commissioner
District Six	Robert Shepperd, Lincoln County Sheriff

## **Ex-Officio Members**

NMC Executive Director	Steve Kopelman
------------------------	----------------

# ADVISORY COUNCIL

Mark Cage, <b>Chair</b>	NMC President Elect & Eddy County Sheriff
Assessors	Linda Gallegos, Colfax County
Attorneys	Nelson Goodin, Doña Ana County
Clerks	Dave Kunko, Chaves County
Commissioners	Robert Corn, Chaves County
Cooperative Ext. Service	John Allen, Socorro County
Detention Administrators	Clay Corn, Chaves County
DWI Coordinators	Kelly Livingston, Lea County
911 Directors	Ken Martinez, Santa Fe County
Finance & Purchasing	Chip Low, Lea County
Fire & Emergency Managers	Paul Quairol, Otero County
GIS/RA	Levon Sink, Union County
Health Services	Amber Mayhall, Otero County
Human Resources	Craig Bova, Lea County
Information Technology	Daniel Garcia, Valencia County
Managers	Amber Hamilton, Roosevelt County
Probate Judges	Tom Pestak, Sierra County
Public Works	Larry Moore, Quay County
Risk Management	Mark Lujan, Santa Fe County
Sheriffs	Tony Mace, Cibola County
Treasurers	Nancy Bearce, Bernalillo County

## **Ex-Officio Members**

NMC Executive Director	Steve Kopelman
------------------------	----------------

# MULTI-LINE POOL BOARD

Ron Lethgo, **Chair**.....Chaves County Deputy Assessor  
Katherine Miller, **Vice Chair**.....Santa Fe County Manager  
Rick Rudometkin, **Secretary/Treasurer** .. Eddy County  
Manager  
Jim Fambro, **NMC Rep.**.....Taos County Commissioner  
Jay Block.....Sandoval County Commissioner  
Lance Pyle.....Curry County Manager  
Shirley Ragin.....Bernalillo County Deputy  
Finance Manager  
Isabella Solis.....Doña Ana County Commissioner  
Bruce Swingle.....Sierra County Manager  
Delilah Walsh.....Socorro County Manager

## Ex-Officio Members

Rebecca Long.....NMC President &  
Lea County Commissioner  
Patrick Trujillo.....NMC LP Attorney

# WORKERS' COMP POOL BOARD

Lance Pyle, **Chair**.....Curry County Manager  
Rick Rudometkin, **Vice Chair**.....Eddy County Manager  
Jim Fambro, **Secretary/Treasurer & NMC Rep.**  
.....Taos County Commissioner  
Mike Cherry.....Quay County Commissioner  
Patricia Miller.....Sandoval County HR Director  
Danny Monette.....Valencia County Manager  
Henry Roybal.....Santa Fe County Commissioner  
Lisa Sedillo-White.....Bernalillo County  
General Services Manager  
Delilah Walsh.....Socorro County Manager  
Vacant.....San Juan County

## Ex-Officio Members

Rebecca Long.....NMC President &  
Lea County Commissioner  
Patrick Trujillo.....NMC LP Attorney

575-524-8812  
[www.hmm-law.com](http://www.hmm-law.com)

**HOLT**  
**MYNATT**  
**MARTÍNEZ P.C.**  
ATTORNEYS

1660 Hickory Loop, Las Cruces, NM 88005





## **Automated Election Services**

7000 Zenith Court NE  
Rio Rancho, New Mexico 87144  
(505) 891-0525  
[electionpeople.com](http://electionpeople.com)

### **NEW MEXICO'S LEADING SOURCE FOR CLERKS, ELECTION ADMINISTRATORS, TREASURERS AND ASSESSORS**

#### **ELECTION MANAGEMENT**

##### **AutoVote E-Pollbook/Ballot Management System**

- Command Center
- ECanvass
- Signature Image Capture
- The Q Voter Check-in System

##### **AutoVote Vote by Mail Management System**

- BallotPak Design and Production
- Ballot Tracking/Management
- Voter Management Database System

##### **Turnkey Election Project Management**

- Complete Technical Service
- Training
- Support

#### **IMAGING AND DATA MANAGEMENT PROJECT SERVICES AND SUPPORT FOR TREASURERS AND ASSESSORS**

- Tax Bills
- Notice of Valuations
- Electronic Tax Bills and Notice of Valuations
- Tax Roll Receipts and Binders
- Manufactured Home Stickers and Move Permits



## **Water / Wastewater ♦ Transportation Site / Civil ♦ Environmental Surveying & Mapping**

*Providing engineering, environmental & surveying services  
for communities throughout the  
Mountain West Region for over 30 years.*



**[www.soudermiller.com](http://www.soudermiller.com)**

*An Employee-Owned Company*



### **NM EDGE**

January 2019 Honing Your NM EDGE  
Monday, January 14 - Wednesday, January 16, 2019

Drury Plaza Hotel  
828 Paseo del Peralta  
Santa Fe, NM 87501

NM EDGE is a service of New Mexico State University's Cooperative Extension Service. It is a program designed to provide a comprehensive course of study to administrators, managers, elected officials, and staff in local, state, tribal, and national government, through which participants can acquire and apply the best practices and theory to their management behaviors and strategies using the highest professional standards.

Questions? Please call (575) 646-0314 or [NMEDGE@nmsu.edu](mailto:NMEDGE@nmsu.edu).

### **Information**

NM EDGE graduation will be held on Thursday, January 17, 2019 at the Santa Fe Community Convention Center at 12:00 p.m. during the Closing Luncheon.

Graduates who are not registered for the full conference will receive complimentary access to the graduation ceremony and luncheon. Graduates are allowed to bring guests, but they will need to purchase a guest ticket.

Guest tickets can be purchased at the NMC Registration Desk for \$25.00 per person.

		Time	CPO Classes	CPS Classes	CPM Classes	Ethics Classes
Monday January 14, 2019	1	8:30 - 11:30 am	<b>CPM 131</b> HR Law	<b>CPM 114</b> Public Policy	<b>CPM 212</b> Contract Obligations (PR=111)	<b>PE 110A</b> Know the Law I
	2	1:00 - 4:00 pm	<b>CPM 113</b> Knowing the Law	<b>CPM 236</b> Success Supervision (113)	<b>CPM 231</b> Workers; Comp & ADA (PR 131)	<b>PE 110B</b> Know the Law I PR=110A
	3	5:30 - 8:30 pm	<b>CPM 144</b> Risk Mgmt.	<b>CPM 123</b> Managing Org Change	<b>CPM 213</b> Policy Dev (PR 114)	<b>PE 120</b> Do the Right Thing
Tuesday, January 15, 20189	4	8:30 - 11:30 am	<b>CPM 122</b> Congrats! You're A Leader (112)	<b>CPM 222</b> Project Mgmt. (112)	<b>CPM 233</b> Employee Relations (PR=131)	<b>CPM 112</b> Answering the Call Public Service
	5	1:00 - 4:00 pm	(157)	<b>CPM 157</b> Creating a Service Oriented Culture	<b>CPM 137</b> Discipline & Term.	<b>PE 128</b> Walk the Talk
Wednesday, January 16, 2019	6	8:30 - 11:30 am	<b>CPM 121</b> Ethics & Profession- alism	<b>CPM 132</b> Eliminating Discrimina- tion in the Workplace	<b>CPM 143</b> Purchasing & Procurement (153)	(121) (153)



AO	CL Classes	CO Classes	TO Classes	CES Classes	EDS Classes	GIS Classes
<b>AO 112</b> Tax Exempt Props (131) (114)	(131)	<b>CO 141</b> Sources of Public Finance (PE110A) (212)	<b>TO 101</b> for Treas	(114)		(131)
<b>AO 109</b> Assess- ment Calendar	(113)	<b>CO 131</b> Employ- ment Law (113) (PE110B)	<b>TO 103</b> Legal Issues for Treas (113)			
<b>AO 103</b> Title Convey- ance	<b>CL 106</b> Census & Redistrict (144)	(144)	(144)			(144) (123)
<b>AO 105</b> Certs Abstracts & Warrants	<b>CL 104</b> Calendar & Special Elections (112)	<b>CO 102</b> County Srvcs: (112)	(222) (112)	(122) (112)		
<b>AO 106</b> Budget & Revaluation Plan		<b>CO 103</b> County Srvcs: Health, Welfare		(157)		<b>GIS 101</b> Core Geo (157)
<b>AO 104</b> Property Appeal (121)	(121) (132) (153)	<b>CPM 153</b> Public Meetings (121) (EDS102)	(132) (143)	(121) (132)	<b>EDS 102</b> Economic Dev Resources <b>Cancelled</b>	<b>GIS 104</b> Cord. Systems

		Time	IT Classes	JPS Classes	NMF Classes	NMP Classes	RM Classes
Monday January 14, 2019	1	8:30 - 11:30 am		(131)	(131)	(131)	(131)
	2	1:00 - 4:00 pm		(236) (231)	(231)	(236)	(231) (236)
	3	5:30 - 8:30 pm	(144) (123)	(144)	(144)		<b>RM 139</b> Safe Orient (144) (123) <b>Cancelled</b>
Tuesday, January 15, 2019	4	8:30 - 11:30 am	(222)		(233)	(112)	(222)
	5	1:00 - 4:00 pm		(137)	(AO 106)		<b>RM 244</b> Loss Prev (PR=1 44)
Wednesday, January 16, 2019	6	8:30 - 11:30 am	(121)	(121) (143)	(121) (143)	(121)	(121) (143)



**RBC Capital Markets**

## Proud to Support New Mexico Counties

RBC Capital Markets is a market leader of municipal finance in New Mexico and nationwide. We combine our local market expertise and comprehensive resources to deliver custom solutions that assist our clients in achieving their financing goals.

[rbccm.com/municipalfinance](http://rbccm.com/municipalfinance)

Source: Thomson Reuters. This advertisement is for informational purposes only. RBC Capital Markets is the global brand name for the capital markets business of Royal Bank of Canada and its affiliates, including RBC Capital Markets, LLC (member FINRA, NYSE and SIPC). ®/™ Trademark(s) of Royal Bank of Canada. Used under license. © Copyright 2018. All rights reserved.

# Kofile

Powering Modern Government

**The Market Leader  
for Information Management  
and Software Solutions  
for Local Governments**

[www.kofile.com](http://www.kofile.com)  
[info@kofile.com](mailto:info@kofile.com)  
214.442.6668

 **GSA** Contract Holder



# SPONSORS

Thank You to our Sponsors!

## Bronze Sponsor Conference Bag



## Conference Lanyard Sponsor



## Conference Program Sponsor



## Business Center Sponsor



Abba Technologies, Inc.  
 Ambitions Consulting Group  
 Aquila  
 Autoagent Data Solutions  
 Automated Election Services  
 CamNet, Inc.  
 Computer Information Systems, Inc  
 Cooperative Educational Services  
 Curry County  
 Dominion Voting  
 Don Chalmers Ford  
 Dustrol, Inc.  
 Election Systems & Software  
 FNF Construction Inc.  
 Forte Payment Systems  
 GM Emulsion, LLC  
 Hilltop Securities, Inc.  
 Indigent Healthcare Solutions  
 Inland Kenworth US, Inc.  
 J-Mar and Associates, Inc.  
 JailTracker  
 Kofile Technologies, Inc.  
 MCT Industries  
 Mooring USA-NM  
 NCIC Inmate Communications  
 New Mexico Finance Authority  
 New Mexico Municipal League  
 Pettigrew & Associates P.A.  
 Professional Document Systems  
 Quest Software  
 Robis Elections  
 RoofCARE  
 Santa Fe Education Trust Board  
 SealMaster Albuquerque  
 Siddons-Martin Emergency Group  
 Souder, Miller & Associates  
 Summit  
 Systems MD  
 The Master's Touch, LLC  
 Trac  
 Triadic Enterprises, Inc.  
 Tyler Technologies  
 Universal Waste Systems of New Mexico  
 VFIS  
 VitalCore Health Strategies  
 Wagner Equipment  
 WDC  
 Wellpath  
 Wilson & Company

# SPONSORS' RECEPTION

## Sponsors' Reception

**Santa Fe Convention Center  
Sweeney Ballroom  
Tuesday, January 15, 2019  
5:00 p.m. - 7:00 p.m.**

*Light Hors d'oeuvres & Cash Bars*

## Sponsors' Reception Sponsors



# **LIUNA!**

## **LABORERS LOCAL 16**



**BUILDS PEOPLE  
BUILDS PROJECTS  
BUILDS NEW MEXICO**

LIUNA Local 16 partners with public and private entities, elected officials, community groups, and responsible contractors to build and maintain infrastructure needs of communities across New Mexico and provide residents a career in the construction industry.

**BUILD BETTER  
BUILD SAFER  
BUILD with LIUNA!**

Laborers' International Union of North America  
Local 16

(888) 844-4612  
[www.LIUNA16.org](http://www.LIUNA16.org)

# WORKSHOP BLOCKS

## Workshop Block I 8:30 a.m. - 9:45 a.m.

**Wednesday, January 16, 2019**  
**Santa Fe Community Convention Center**

.....

### **Behavioral Health Block I** **O'Keeffe/Kearny/Milagro**

Promising Programs: Improving Public Safety  
& Fostering Economic Development by  
Addressing Behavioral Health Needs

- San Miguel County detention reintegration pilot program
- McKinley County ADC jail treatment program
- Sierra/Catron/Valencia/Socorro counties behavioral health continuum of care & economic development

#### Presenters:

Matt Elwell, San Miguel County Detention Administrator

Dr. Erika Hayes, McKinley County Treatment Program Creator & Manager

Dr. Anne Hays Egan, New Ventures Consulting

Workshop Moderated by Jamie Michael,  
Director Doña Ana County HHS Department

.....

### **Wrangling the Roundhouse** **Coronado/De Vargas**

Legislative Priorities and Lobbying Tips

#### Presenters:

Brian Moore, New Mexico Counties Government Relations

Steve Kopelman, New Mexico Counties Executive Director



**Workshop Block II**  
**10:15 a.m. - 11:30 a.m.**

**Wednesday, January 16, 2019**  
**Santa Fe Community Convention Center**

.....

**Behavioral Health Block II**  
**O'Keeffe/Kearny/Milagro**

Implementing Centennial Care 2.0: Bringing  
Managed Care Organizations Into County Jails

Presenters

Dr. Wayne Lindstrom, Director Behavioral  
Health Services Division HSD

Kathy Slater-Huff, Communication & Education  
Bureau Chief HSD

Jeanelle Romero, JUST Health Program  
Manager HSD

Grace Philips, New Mexico Counties General  
Counsel

Workshop Moderated by Jamie Michael,  
Director Doña Ana County HHS Department

.....

**Audits, Executive Order 2013-06,**  
**& Troubled Counties**  
**Coronado/De Vargas**

Discussion of Actual Cases Where Poor Fiscal  
Responsibility Has Adversely Affected Counties'  
Ability to Manage Their Own Funding.

Presenters:

Michael Steininger, Department of Finance &  
Administration Local Government Division  
Special Director

Santiago Chavez, New Mexico Counties  
Administration & Finance Director



# **CES has a contract for that!**

Buying through CES keeps your money in NM

As an extension of your purchasing department, we do the hard work, solicitation, evaluation and award saving you time and money on hundreds of goods and services.

**Construction**

**Heavy Equipment** (John Deere, CAT, Case)

**Cars, Trucks, Pickups** (GM, Ford, Chrysler/Dodge)

**Heavy Duty Trucks** (Peterbilt, Freightliner, Mack, Volvo, Kenworth, International)

**Bulk Fuel** (gas, diesel)

**Architect/Engineering**

**Police Vehicles** (Ford, Dodge)

**Technology & Software**

**Temporary Staffing**

**Fire Trucks & Emergency Vehicles**

**Security Equipment & Systems**

**Playground Equipment**

**Recreational Facilities & Equipment**

**Landscaping**

**CES** is  
**NEW MEXICO** *True*  
LOCAL • COMPLIANT • EASY

**[www.ces.org](http://www.ces.org)**

**505-344-5470**

## Opening General Session

**Santa Fe Community Convention Center  
Sweeney Ballroom**

**Wednesday, January 16, 2019**

**1:00 p.m. – 2:15 p.m.**

### **Call to Order**

*President & Lea County Commissioner  
Rebecca Long*

### **Presentation of Colors & National Anthem**

### **Introductions**

*Head Table and Special Guests*

### **Welcome to Santa Fe & Opening Remarks**

*Santa Fe County Commission Chair*

*City of Santa Fe Mayor Allen Webber*

### **Guest Speaker**

*NACo Past President & Leon County  
Commissioner Bryan Desloge*

*President Long calls for a recess until  
7:15 a.m. on Thursday, January 17, 2019.*



### **NACo Past President Bryan Desloge**

Bryan Desloge was elected President of NACo in July 2014. Desloge also holds several positions within the organization, including the Health Steering Committee, Financial Services Corpora-

tion Board of Directors and the Next Generation NACo Network. He was elected to a two year term of office in 2006 as Leon County Commissioner and was reelected to four year terms in 2008, 2012, and 2016.

# LEGISLATIVE RECEPTION

## Legislative Reception & Dance

**Eldorado Hotel and Spa  
Eldorado Ballroom and Cava Lounge  
Wednesday, January 16, 2019  
5:30 p.m. - 10:30 p.m.**

*Reception, Cash Bars, & Dancing*

Entertainment provided by:  
The Brandon Saiz Band

## **Entertainment Sponsors**



## **Drink Ticket Sponsors**





# TRI-STATE

Generation and Transmission  
Association, Inc.

A Touchstone Energy® Cooperative



## Proud to energize the Land of Enchantment.

[www.tristate.coop](http://www.tristate.coop)



# Triadic Enterprises, Inc.

~ A Triune of Computer Services ~

Our mission is to ensure the success of our governmental customers in the state of New Mexico by providing software designed especially for New Mexico's needs and laws, providing a high level of customer service, and utilizing the most current technology available. At Triadic we work to focus the customer's resources, so the customer can concentrate on business needs.

## Software that Works for You!

[www.triadicnet.com](http://www.triadicnet.com) 1-800-221-0653 [tei@triadicnet.com](mailto:tei@triadicnet.com)

# LEGISLATIVE BREAKFAST

## **Legislative Breakfast**

**Santa Fe Community Convention Center  
Sweeney Ballroom**

**Thursday, January 17, 2019**

**7:15 a.m. - 8:30 a.m.**

*Doors Open 6:45 a.m.*

*Breakfast Service 6:45 a.m. to 7:15 a.m.*

### **Call to Order**

*President & Lea County Commissioner  
Rebecca Long*

### **Introductions**

*Head Table and Special Guests*

### **New Mexico Counties**

#### **Legislative Priorities & Report**

*NMC Government Relations Brian Moore*

### **New Mexico Governor**

*Honorable Michelle Lujan Grisham (Invited)*

### **Senate Leadership**

*President Pro Tempore Mary Kay Papen (Invited)*

### **House of Representatives**

*Patricia "Patty" Lundstrom (Invited)*

*President Long calls for a recess until  
12:00 p.m. on Thursday, January 17, 2019.*



## **New Mexico Governor Michelle Lujan Grisham**

Michelle Lujan Grisham, a 12th-generation New Mexican, has dedicated her life to serving her community, fighting for seniors and veterans, and building an economy that works for all New Mexicans. On November 6, 2018, she became the first Democratic woman elected as governor of New Mexico.

.....



## **President Pro Tempore Senator Mary Kay Papen**

Mary Kay Papen was first elected to represent District 38 in the New Mexico State Senate in 2000 and was selected as the President Pro Tempore in 2013. She has been an important advocate for mental health policies and received the 2012 State Legislator of the Year Award in recognition of her efforts to support behavioral health access and awareness.

.....



## **NM House of Representatives Patricia "Patty" Lundstrom**

Patty Lundstrom was elected to represent District 9 in 2003. Lundstrom served consecutively from January 2001 until January 2003 in the District 5 seat. She is the Chair of the House Appropriations & Finance Committee, and a standing committee member for the House Transportation, Public Works & Capital Improvements committee.

# DOMINION VOTING



Dominion Voting is proud to support the  
NMAC as your voting systems vendor!



#### Get in touch

Steven Bennett | Regional Sales Manager  
[steven.bennett@dominionvoting.com](mailto:steven.bennett@dominionvoting.com)  
909.362.1715

## WAGNER EQUIPMENT CO. HAS PARTNERED WITH



**CES MAKES PURCHASING SIMPLE FOR  
MEMBERS AND PARTICIPATING ENTITIES**

Contact your Wagner Sales Representative  
for information on the CES contract

**New Mexico** 1-800-432-6612

**WAGNER**





# CLOSING LUNCHEON

## **Closing Luncheon & NM EDGE Graduation**

**Santa Fe Community Convention Center  
Sweeney Ballroom**

**Thursday, January 17, 2019**

**12:00 p.m. - 1:30 p.m.**

*Doors Open 11:45 a.m.*

*Lunch Service 11:45 a.m. to 12:15 p.m.*

### **Call to Order**

*President & Lea County Commissioner  
Rebecca Long*

### **Introductions**

*Head Table and Special Guests*

### **Audit & Accountability Awards**

*State Auditor Brian Colón*

### **Workers' Compensation Pool Safety Awards**

### **Risk Awareness Program (RAP) Awards**

### **Emergency Communications Accreditation**

### **Adult Misdemeanor Compliance Accreditation**

### **NM EDGE County College Graduation**

*NMSU Associate Dean & Director of Cooperative  
Extension Service Jon Boren and NM EDGE  
Program Director Mary DeLorenzo*

### **Announcements & Door Prize Drawings**

### **Adjournment**



THE PAPER TRAIL ENDS  
HERE

Simplified Office Solutions

www.pdswest.com

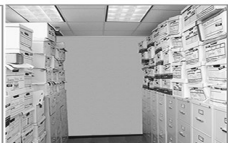
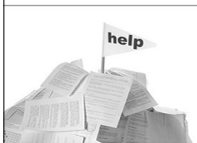

#### DOCUMENT MANAGEMENT

Turn Key systems to create a paperless office

#### SCANNING SERVICES

Let PDS Scan and Index your critical records

#### AUTOMATED FORMS

Simplify Business Process using Electronic Automated Forms



#### AGENDA MANAGEMENT

Easy-to-use paperless agendas and meetings

#### CUSTOM SOFTWARE SOLUTIONS

For unique business processes and AP automation

#### SCANNERS

Document, Check, Large Format and Microfilm



LOCAL ● COMPLIANT ● EASY

**Gain the Local buying power of New Mexico's largest statewide cooperative. Check out our contract offerings today!**

**We are your fast-track to cost-effective cooperative buying that delivers:**

- Compliance
- Value
- Transparency
- Accountability

www.ces.org

505-344-5470

# AFFILIATE LOCATIONS

## **Affiliate Meeting Locations**

**Drury Plaza Hotel (Drury)**  
**Eldorado Hotel and Spa (Eldorado)**  
**Santa Fe Community Convention Center (SFCCC)**

<u><b>Affiliate</b></u>	<u><b>Venue - Room Name</b></u>
g11 Directors	SFCCC - Ohkay Owingeh
Assessors	Eldorado - Anasazi South
Attorneys	SFCCC - Tesuque Boardroom
Clerks	Drury - O'Keeffe
Commissioners	SFCCC - O'Keeffe/Kearny/Milagro
Cooperative Extension Service	Eldorado - Zia A & B
Detention Administrators	SFCCC - Nambe
DWI Coordinators	Drury - Lamy
Finance & Purchasing	SFCCC - Peralta
Fire & Emergency Managers	Drury - Palace A Ballroom
GIS/RA	SFCCC - Pojoaque
Health Services	Drury - Palace B Ballroom
Human Resources	SFCCC - Lamy
Information Technology	Drury - Rivera B
Managers	SFCCC - Coronado/DeVargas
Probate Judges	Eldorado - Zia C
Public Works	Drury - Meem
Risk Management	Drury - Rivera A
Sheriffs	Eldorado - De Vargas
Treasurers	Eldorado - Anasazi North

# 911 DIRECTORS

SFCCC - OHKAY OWINGEH

## Wednesday, January 16, 2019

### **2:30 p.m. Call to Order**

Affiliate Business

*Presented by Affiliate Chair*

### **3:00 p.m.**

Meeting with DoIT

(Joint with GIS Affiliate)

*Presented by Bill Range & Victoria Garcia*

### **3:45 p.m. Break**

### **4:00 p.m.**

Update and Discussion on Legislative  
Issues

Presentation of Bill Draft

*Presented by Ken Martinez & Dave Ripley*

### **5:00 p.m. Recess**

---

## Thursday, January 17, 2019

### **8:45 a.m. Reconvene**

### **9:00 a.m.**

Discussion on Next Generation 911 and  
Briefing on Presentation From the  
Science, Technology and  
Telecommunications Interim Legislative  
Committee

*Presented by Dave Ripley*

### **10:15 a.m. Break**

### **10:30 a.m.**

Planning and Discussion Regarding Bylaws  
for the NM Municipal League

*Presented by Ken Martinez & Mariah Valdez*

### **11:45 a.m. Adjourn**

## ELDORADO HOTEL—ANASAZI SOUTH

**Wednesday, January 16, 2019****2:30 p.m. Call to Order**

Affiliate Business

*Presented by Affiliate Chair***3:00 p.m.**

Presentation – NM Military Museum

*Presented by Ken Dettelbach***3:45 p.m. Break****4:00 p.m.**

Presentation - The Sidwell Company

*Presented by Vice President Tony**Pellettierre***4:30 p.m.**

Presentation - Marketing Strategies

*Presented by Owner Tony Medrano***4:45 p.m.**Committee Reports: AG, Education, GIS,  
IAAO Chapter**5:00 p.m. Recess****Thursday, January 17, 2019****8:45 a.m. Reconvene****9:00 a.m.**

Axiomatic System Modernization Update

Followed by Q&amp;A and Discussion

(Joint with Treasurers Affiliate)

*Presented by Dave Salzer & Larry Brotman***10:30 a.m. Break****10:45 a.m.**

Old Business/New Business Including:

Discussion Legislative Priorities for 2019

60-Day Session

- Disclosure

- Property Tax Initiative (2018 HB 163)

- Incentive Compensation for Assessors

**11:45 a.m. Adjourn**

# ATTORNEYS

SFCCC—TESUQUE BOARDROOM

## Wednesday, January 16, 2019

**2:30 p.m.      Call to Order**

Affiliate Business

*Presented by Affiliate Chair*

**2:45 p.m.**

1983 Civil Rights Claims – An Overview  
(Pending MCLE Credit, 1 hr)

*Presented by Cody Rodgers*

**3:45 p.m.      Break**

**4:00 p.m.**

ICE Detainers

(Pending MCLE Credit, 1 hr)

**5:00 p.m.      Recess**

---

## Thursday, January 17, 2019

**8:45 a.m.      Reconvene**

**9:00 a.m.**

Right to Counsel in Civil Cases

*Presented by John Pollock*

**10:15 a.m.      Break**

**10:30 a.m.**

Roundtable Discussion

**11:45 a.m.      Adjourn**

DRURY—O'KEEFFE BALLROOM

**Wednesday, January 16, 2019****2:30 p.m.      Call to Order**

Affiliate Business

*Presented by Affiliate Chair***2:45 p.m.**

New Mexico Secretary of State

*Presented by Maggie Toulouse-Oliver, John Blair, Mandy Vigil, and Rebecca Martinez***3:45 p.m.      Break****4:00 p.m.**

Elected County Clerks Session

*Elected County Clerks Only***5:00 p.m.      Recess**

---

**Thursday, January 17, 2019****8:45 a.m.      Reconvene**2018 General Election, Recount, Audit,  
Special School Elections, & Local Election  
Act**10:00 a.m.**Legislation: Election Restructuring Bill,  
Other Introduced Legislation Affecting  
County Clerks*Presented by Policy & Legislative Teams***10:15 a.m.      Break****10:30 a.m.**

Affiliate Discussion Continued

**11:45 a.m.      Adjourn**

# COMMISSIONERS

SFCCC—O'KEEFFE/KEARNY/MILAGRO

## Wednesday, January 16, 2019

### **2:30 p.m. Call to Order**

Affiliate Business

*Presented by Affiliate Chair*

### **2:40 p.m.**

Treasurer's Report

### **2:45 p.m.**

Payment in Lieu of Taxes (PILT) and Secure Rural Schools (SRS) Funding

*Presented by Rural Public Lands County*

*Council Representative Robert K. Weidner*

### **3:45 p.m. Break**

### **4:00 p.m.**

PILT & SRS Discussion Continued

### **5:00 p.m. Recess**

---

## Thursday, January 17, 2019

### **8:45 a.m. Reconvene**

### **9:00 a.m.**

NMC Services, Legislative Priorities, and Effective Lobbying

*Presented by NMC Executive Director Steve*

*Kopelman and NMC Government Relations*

*Brian Moore*

### **10:00 a.m. Break**

### **10:15 a.m.**

Do You Know What Your Single Biggest Liability Is? Developments in Detention Operations

*Presented by NMC Executive Director Steve*

*Kopelman and NMC General Counsel Grace*

*Philips*

### **11:45 a.m. Adjourn**



# COOPERATIVE EXTENSION

ELDORADO—ZIA A & B

## Wednesday, January 16, 2019

**2:30 p.m.      Call to Order**  
Affiliate Business  
*Presented by Affiliate Chair*

**3:00 p.m.      Break**

**3:15 p.m.**  
Professional Development & Supervisory  
Training

**5:00 p.m.      Recess**

.....

## Thursday, January 16, 2019

**8:45 a.m.      Reconvene**

**8:50 a.m.**  
Continue Professional Development &  
Supervisory Training

**10:15 a.m.      Break**

**11:45 a.m.      Adjourn**

NOTES

---

---

---

---

---

---

---

---

---

---

# DETENTION ADMINISTRATORS

SFCCC—NAMBE

**Wednesday, January 16, 2019**

**2:30 p.m.      Call to Order**

Affiliate Business

*Presented by Affiliate Chair*

**2:40 p.m.**

Jury Trial Lessons Learned: Claim Alleging  
Failure to Provide Adequate Medical Care  
Resulting in Death

*Presented by NMC Multi-Line Claims*

*Manager Robin Martinez*

**3:10 p.m.      Break**

**3:25 p.m.**

Special Management Committees - An  
Interactive Demonstration

*Presented by NMC General Counsel Grace  
Philips and NMC Loss Prevention Specialist  
Art Murphy*

**4:00 p.m.**

Developments in ICE Detainer Caselaw

Inmate Mail Cases

Strip Searches after *Florence*

Medication Assisted Treatment in County  
Jails

*Presented by NMC General Counsel Grace  
Philips*

**5:00 p.m.      Recess**

# DETENTION ADMINISTRATORS

SFCCC—NAMBE

**Thursday, January 17, 2019**

**8:45 a.m. Reconvene**

CYFD Revised Standards for Juvenile Facilities

*Presented by Traci Neff & Art Murphy*

**9:10 a.m.**

Adult Detention Officer Revised Training Curriculum

*Presented by Art Murphy*

**9:40 a.m.**

Mobile Compliance Technology – 1084 Solutions

*Presented by Donald Rupe*

**10:10 a.m. Break**

**10:30 a.m.**

New CYFD Juvenile Detention Compliance Monitor

*Presented by Samantha Lucas*

**10:45 a.m.**

NM EDGE 2019 On-Line Detention Certification Schedule

*Presented by NM EDGE Program Director Mary DeLorenzo*

**11:00 a.m.**

Census 2020 What's at Stake for NM (Joint with GIS Affiliate)

*Presented by US Census Bureau Partnership Specialist Veronica Arzate De Reyes*

**12:00 p.m. Adjourn**

# DWI COORDINATORS

DRURY—LAMY

## Wednesday, January 16, 2019

**2:30 p.m. Call to Order**

Affiliate Business

*Presented by Affiliate Chair*

**2:45 p.m.**

Globosocks, LLC Break

*Presented by Gregory Webb*

**3:15 p.m.**

Choice Recovery Path

*Presented by Marc Schmallen*

**3:45 p.m. Break**

**4:00 p.m.**

Responsible Gaming Association of NM

*Presented by Rebecca Beardsley*

**5:00 p.m. Recess**

---

## Thursday, January 17, 2019

**8:45 a.m. Reconvene**

**8:50 a.m.**

Coordinator Training

*Presented by NM EDGE Program Director*

*Mary DeLorenzo*

**9:20 a.m.**

DFA - 2020 Application Process

*Presented by DFA Bureau Chief Julie*

*Krupcale*

**10:00 a.m. Break**

**10:15 a.m.**

DFA - 2020 Application Process Continued

**11:45 a.m. Adjourn**

# FINANCE & PURCHASING

SFCCC—PERALTA

## Wednesday, January 16, 2019

### **2:30 p.m. Call to Order**

Affiliate Business

*Presented by Affiliate Chair*

### **3:00 p.m.**

Meet the New Mexico State Auditor

(Joint with Managers Affiliate)

*Presented by NM State Auditor Brian Colón*

### **3:30 p.m. Break**

### **3:45 pm**

Current County Finance Issues

*Presented by Patillo, Brown & Hill CPA*

*Chris Garner*

### **5:00 p.m. Recess**

---

## Thursday, January 17, 2019

### **8:45 a.m. Reconvene**

Preventing Financial Losses: Check Fraud,  
Wire Fraud, Mobile Banking Fraud, BEC  
Scams and Embezzlement

*Presented by SAFEChecks President*

*Greg Litster*

### **10:00 a.m. Break**

### **10:15 a.m.**

Preventing Financial Losses Continued

### **11:45 a.m. Adjourn**

# FIRE & EMERGENCY MANAGERS

DRURY—PALACE BALLROOM A

**Wednesday, January 16, 2019**

**2:30 p.m.      Call to Order**  
Affiliate Business  
*Presented by Affiliate Chair*

**3:00 p.m.**  
Nomination of Officers

**3:45 p.m.      Break**

**4:00 p.m.**  
Affiliate Resolution Discussion

**4:15 p.m.**  
Old Business

**4:30 p.m.**  
New Business

**5:00 p.m.      Recess**

.....

**Thursday, January 17, 2019**

**8:45 a.m.      Reconvene**  
Review of Current Items for Session

**9:30 a.m.**  
Future Affiliate Projects

**10:15 a.m.      Break**

**10:30 a.m.**  
State Agency Updates

**11:45 a.m.      Adjourn**

## SFCCC - POJOAQUE

**Wednesday, January 16, 2019****2:30 p.m. Call to Order**

Affiliate Business

*Presented by Affiliate Chair***3:00 p.m.**

Meeting with DoIT

(Joint with 911 Affiliate)*Presented by Bill Range & Victoria Garcia***3:45 p.m. Break****4:00 p.m.**

DoIT Q&amp;A Continued

**5:00 p.m. Recess****Thursday, January 17, 2019****9:00 a.m. Reconvene****9:15 a.m.**

The Sidwell Company-GIS Trends in the Industry. Tricks and Tips to Best Leverage the Technology.

*Presented by Vice President Tony Pellettiere***10:00 a.m. Break****10:15 a.m.**

Affiliate Business

**11:00 a.m.**Census 2020 What's at Stake for NM  
(Joint with Detention Administrators  
Affiliate)*Presented by US Census Bureau Partnership  
Specialist Veronica Arzate De Reyes***11:45 a.m. Adjourn**

# HEALTH SERVICES

DRURY - PALACE B BALLROOM

## Wednesday, January 16, 2019

### **2:30 p.m. Call to Order**

Affiliate Business

*Presented by Affiliate Chair*

### **3:00 p.m.**

Health Securities Act

*Presented by Health Security for New  
Mexican Campaigns Executive Director  
Mary Feldblum*

### **3:45 p.m. Break**

### **4:00 p.m.**

Health Policy Committee Update

### **4:30 p.m.**

Round Table - Old Business/New Business

### **5:00 p.m. Recess**

---

## Thursday, January 17, 2019

### **8:45 a.m. Reconvene**

### **9:00 a.m.**

Round Table - Old Business/New Business

### **9:45 a.m. Break**

### **10:00 a.m.**

Round Table - Old Business/New Business

### **11:45 a.m. Adjourn**



# HUMAN RESOURCES

SFCCC - LAMY

## Wednesday, January 16, 2019

**2:30 p.m.      Call to Order**  
Affiliate Business  
*Presented by Affiliate Chair*

**2:45 p.m.**  
Retiree Healthcare Authority  
*Presented by Greg Archuleta*

**3:45 p.m.      Break**

**4:00 p.m.**  
Roundtable Discussion of Benefits

**5:00 p.m.      Recess**

---

## Thursday, January 17, 2019

**8:45 a.m.      Reconvene**  
Medical Marijuana, Random Drug Testing,  
and Fair Pay for Women Act  
(Joint Session with Managers Affiliate)  
*Presented by NMC General Counsel Grace  
Philips*

**9:30 a.m.**  
PERA - Proposed Legislative Changes  
(Joint Session with Managers Affiliate)  
*Presented by Chief Maxon*

**10:15 a.m.      Break**

**10:30 a.m.**  
Best Practices in Records Management  
*Presented by Emmanuel Rodriguez,  
Bernalillo County*

**11:45 a.m.      Adjourn**

# INFORMATION TECHNOLOGY

DRURY—RIVERA B

## Wednesday, January 16, 2019

**2:30 p.m.      Call to Order**

Affiliate Business

*Presented by Affiliate Chair*

**2:45 p.m.**

Roundtable on Current Cyber Threats and  
Issues Within Our Networks

**3:45 p.m.      Break**

**4:00 p.m.**

General Data Protection Regulation (GDPR)

*Presented by Daniel Garcia*

**5:00 p.m.      Recess**

---

## Thursday, January 17, 2019

**8:45 a.m.      Reconvene**

**9:00 a.m.**

Roundtable with New Business

**9:45 a.m.      Break**

**10:00 a.m.**

DHS Cybersecurity Resources for Public  
Infrastructure

**11:45 a.m.      Adjourn**

SFCCC—CORONADO/DEVARGAS

**Wednesday, January 16, 2019****2:30 p.m. Call to Order**

Affiliate Business

*Presented by Affiliate Chair***3:00 p.m.**Meet the New Mexico State Auditor  
(Joint Session with Finance & Purchasing  
Affiliate)*Presented by NM State Auditor Brian Colon***3:45 p.m. Break****4:00 p.m.**Insurance Crisis for Detention Centers:  
Severe Shortage of Risk Financing  
Alternatives for County Jails*Presented by John Chino & Steve Kopelman***5:00 p.m. Recess****Thursday, January 17, 2019****8:45 a.m. Reconvene**Medical Marijuana, Random Drug Testing,  
and Fair Pay for Women Act  
(Joint Session with HR Affiliate)*Presented by NMC General Counsel Grace  
Philips***9:30 a.m.**PERA - Proposed Legislative Changes  
(Joint Session with HR Affiliate)*Presented by Chief Maxon***10:15 a.m. Break****10:30 a.m.**

Roundtable Discussion

**11:30 a.m.**Legislative Update & Effective Lobbying  
*Presented by Brian Moore***12:00 p.m. Adjourn**

# PROBATE JUDGES

ELDORADO - ZIA C

## Wednesday, January 16, 2019

**2:30 p.m.      Call to Order**  
Affiliate Business  
*Presented by Affiliate Chair*

**3:15 p.m.      Break**

**3:30 p.m.**  
Open Discussion - Supreme Court  
Proposal to Amend the Constitution for  
the Purpose of Eliminating Certain  
Probate Positions

**5:00 p.m.      Recess**

.....

## Thursday, January 18, 2018

**8:45 a.m.      Reconvene**  
Develop Strategy to Improve the Image  
and Perception of All NM Probate Judges  
and Look for Ways to Expand the Judicial  
Authority  
*Presented by Judge Tom Pestak*

**10:00 a.m.      Break**

**11:45 a.m.      Adjourn**

NOTES

---

---

---

---

---

---

---

---

DRURY—MEEM

## **Wednesday, January 16, 2019**

### **2:30 p.m. Call to Order**

Affiliate Business

*Presented by Affiliate Chair*

### **3:00 p.m.**

ROADEO Discussion and Sponsor  
drawing for equipment

### **3:20 p.m.**

Asphalt Pavement Association of NM

### **3:40 p.m. Break**

### **4:00 p.m.**

Lithified Technologies

### **4:30 p.m.**

NMDOT Environmental Bureau

*Presented by Brian Cribbin*

### **5:00 p.m. Recess**

---

## **Thursday, January 17, 2019**

### **8:45 a.m. Reconvene**

### **9:00 a.m.**

Westt LLC - Update on Procurement and  
Procedures

### **9:30 a.m.**

Holly Frontier

### **10:00 a.m. Break**

### **10:15 a.m.**

Deputy Secretary of Transportation

### **11:00 a.m.**

P&M Signs

### **11:15 a.m.**

Closing Remarks or Concerns

### **11:30 a.m. Adjourn**

# RISK MANAGEMENT

DRURY - RIVERA A

## Wednesday, January 16, 2019

### **2:30 p.m. Call to Order**

Affiliate Business

*Presented by Affiliate Chair*

### **2:45 p.m.**

NM EDGE

*Presented by NM EDGE Program Director*

*Mary DeLorenzo*

### **3:15 p.m. Break**

### **3:30 p.m.**

Stay at Work Return to Work

*Presented by Spine Solutions Representative*

*Gina Sandoval*

### **5:00 p.m. Recess**

---

## Thursday, January 17, 2019

### **8:45 a.m. Reconvene**

### **9:00 a.m.**

Origami Overview

*Presented by NMC Risk Management Data*

*Analyst Lori Urban*

### **10:00 a.m. Break**

### **10:15 a.m.**

WC Claims

*Presented by NMC Nurse Case Manager*

*Ellen Chavez*

### **11:00 a.m.**

Open Discussion

### **11:45 a.m. Adjourn**

## ELDORADO—DEVARGAS

**Wednesday, January 16, 2019****2:30 p.m.      Call to Order**

Affiliate Business

*Presented by Affiliate Chair***2:45 p.m.**Newly Elected Sheriffs Welcome,  
Orientation with Sitting Sheriffs, and  
Cross Commissioning*Presented by NMSA Executive Board***4:00 p.m.      Break****4:15 p.m.**NMSA Executive Board Only Meeting  
Sheriffs Institute Planning and  
Executive Director*Presented by NMSA President Tony Mace***5:00 p.m.      Recess****Thursday, January 17, 2019****9:00 a.m.      Reconvene****9:15 a.m.**

Legislative Issues:

Marijuana Bill, 2nd Amendment Concerns,  
Forfeiture Bill, Bail Bond Reform, and LAPF*Presented by Sheriff Mark Cage &  
Sheriff Glenn Hamilton*

NRA Lobbyist Introduction to NMSA

*Presented by Tara Mica***11:45 a.m.      Adjourn**

# TREASURERS

ELDORADO - ANASAZI NORTH

## Wednesday, January 16, 2019

### **2:30 p.m. Call to Order**

Affiliate Business

*Presented by Affiliate Chair*

### **2:45 p.m.**

Legislative Priorities

*Presented by Laura Montoya & Nancy Bearce*

### **3:45 p.m. Break**

### **4:00 p.m.**

Presentation and Discussion on Risk

*Presented by State Treasurer's Office*

*Representative Michael Arnold*

### **5:00 p.m. Recess**

---

## Thursday, January 17, 2019

### **8:45 a.m. Reconvene**

### **9:00 a.m.**

Axiomatic System Modernization Update

Followed by Q&A and Discussion

(Joint with Assessors Affiliate)

*Presented by Dave Salzer & Larry Brotman*

### **10:30 a.m. Break**

### **10:45 a.m.**

Reporting Collateral

*Presented by Bernalillo Accounting Manager*

*Ryan Travelstead*

### **11:30 a.m.**

Wrap Up/Closing

*Presented by Susan Trujillo*

### **11:45 a.m. Adjourn**



**Pavement**  
*Sealants*

**We Do Dental.**  
*Better.*



**DELTA DENTAL®**

## NOTES

[illegible]

[illegible]

# AMBI<sup>ITIONS</sup>

*Consulting Group*

Leveraging  
technology to  
better serve our  
communities

- Back Scanning and Document Archiving
- Full Service Print & Imaging Solutions
- Networking and Technology Upgrades
- Managed IT Services

[ambitionsgroup.com](http://ambitionsgroup.com)